

# Surf N Splash Instructions



## Setup

1. Lay down tarp
2. Take out the slide and roll out the slide on top of the tarp
3. Attach the air intake tube and turn on the blower motor
4. Inflate the Slide
5. Tie shut the air release chute/tube
6. Secure the slide with ground stakes
7. Fill the anchor bags with water
8. Attach/Clip the anchor bags into place
9. Attach and line the sprayer hoses to the velcro spots
10. Connect the sprayer hose to your garden hose

### \*NOTE\*

- In case of rain please make sure to cover over the blower motor so it won't get wet
- The air blower has to be constantly kept on, to keep the slide inflated while children are playing

## Take Down

1. **Two and a half hours before take down**, disconnect your garden hose and stop running water on the slide
2. **Release the drain valve** on the slide to drain the water
3. Disconnect the sprayer hoses from the slide and let it dry out
4. Disconnect the anchor bags and drain the water from the bags
5. Unsecure the ground stakes
6. Open the air release chute/tube
7. Turn off the blower motor and unattached the air intake tube
8. Let the slide deflate, it may take up to 10 minutes for deflation
9. Roll the slide like a camping tent and put inside its bag.
10. Fold the tarp and put it inside the bag

### \*NOTE\*

- If you feel that the slide is still wet, please put the rolled slide in the provided heavy duty plastic bag.

# Surf N Splash Instructions



## CONSTANT AIR INFLATABLES SET UP STEPS

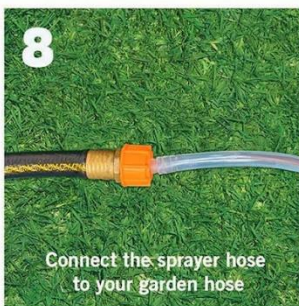
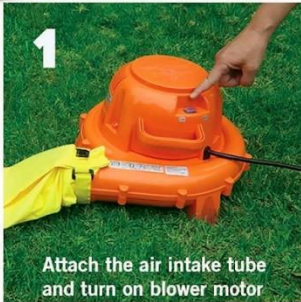

Detailed set up instructions included with your constant air inflatable.